

## Sendzimir Mill Bearings

**BMI has provided CRB for back up rolls with high precision contributing to the utmost performance in multi-roll mills.**

CRB for back up rolls play a significant role in obtaining high level of efficiency.

BMI has provided CRB for back up rolls with high precision contributing to the utmost performance in multi-roll mills.

The Outer Surface of the bearing is manufacture

through crowning which accounts for the contact stress distributed to prevent damage to the intermediate roll due to edge load.

By ensuring that high precision in both the variation of the bearing's section heights and high rotation accuracy is achieved for optimum distribution of the bearing loads and supporting the development in rolling precision and the quality of the coils.

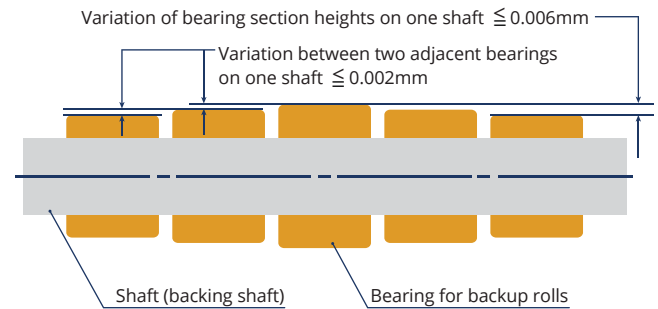

By ensuring that high precision in both the variation of the bearing's section heights and high rotation accuracy is achieved for optimum distribution of the bearing loads and supporting the development in rolling precision and the quality of the coils

**BMI regularly produces this range of sizes :**

d (FW)	D	T	C
31.75	76.2	46.23	45.85
54.999	120	25.999	25.999
55	120	52.197	52
70	160	90	90
70	160.07	90	90
90	190	100	100
100	225.021	80	80
100	225.021	120	120
100	225	100	100
99.995	225	120	120
130	300	160	159.5
130	300	172.644	172.644
130	300	172.644	172.644
180	406.42	171.04	171.04
180	406.42	171.04	171.04
180	406.42	171.04	171.04
179.984	406.43	223.96	217
179.984	406.43	224.25	220



Feel free to contact our engineering team on [design@bmibearings.com](mailto:design@bmibearings.com) for more information or any questions.

More details on the next page

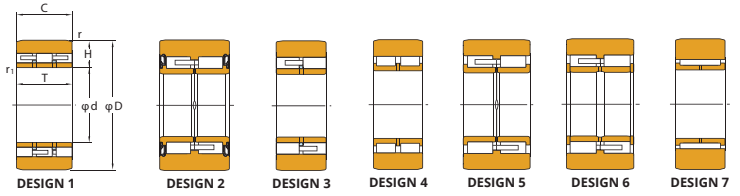

d(Fw)	D	T	C	Bearing No.	BMI Bearing No.	Bearing section height when manufactured (mm) H	Mass (kg)	Amount of bearings required per mill	Applicable multiroll mill type
31.75	76.2	46.23	45.85	06DC0846A	06DC0846ABMI	22.2	1.27	40	ZR34
54.999	120	25.999	25.999	11N1226V	11N1226VBMI	32.4672	1.69	24,56	ZR24
55	120	52.197	52	11DC1252	11DC1252BMI	32.483	3.27	40	ZR24
70	160	90	90	14DC1690LDS-1	14DC1690LDS-1BMI	44.977	10.1	40	ZR33
70	160.07	90	90	14DC1690ADS	14DC1690ADSBI	45	10.5	32,48,72	ZR33
90	190	100	100	18DC19100NDS	18DC19100NDSBBI	49.98	14.7	48	ZR25
100	225.021	80	80	20DC23080DS	20DC23080DSBBI	62.474	18.2	12(36)	ZR23
100	255.021	120	120	20DC23120MDS	20DC23120MDSBBI	62.474	27.2	32	ZR23
100	225	100	100	20DC23100NDS-1	20DC23100NDS-1BBI	62.48	21.7	40	ZR23
99.995	225	120	120	20DC23120KDS-2	20DC23120KDS-2BBI	62.474	26	32,40,48	ZR23
130	300	160	159.5	26DC30160DS	26DC30160DSBBI	84.96	64.8	40,48	ZR22
130	300	172.644	172.644	26DC30170MDS	26DC30170MDSBBI	84.96	72.6	40,48	ZR22
130	300	172.644	172.644	26DC30170KDS-3	26DC30170KDS-3BBI	84.96	70	40,48	ZR22
180	406.42	171.04	171.04	36DC41171DS	36DC41171DSBBI	113.16	130	48,56	ZR21
180	406.42	171.04	171.04	36DC41171ADS	36DC41171ADSBI	113.16	124	48,56	ZR21
180	406.42	171.04	171.04	36DC41171KDS	36DC41171KDSBI	113.16	125	48	ZR21
179.984	406.43	223.96	217	36DC41217DS+DP	36DC41217DS+DPBBI	113.16	161	40,48	ZR21
179.984	406.43	224.25	220	36DC41224KDS	36DC41224KDSBI	113.18	160	32,48	ZR21
180	406.42	224.25	224	36DC41224QDS	36DC41224QDSBI	113.16	162	40,48	ZR21

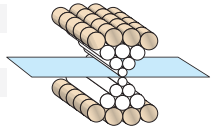

50	110	44.4	44.4	10NUP1144	10NUP1144BBI	-	2.33	-	ZR22,ZR21
50	125	48	46	10NUP1346/48	10NUP1346/48BBI	-	3.39	-	ZR21
50	125	52	52	10NUP1352	10NUP1352BBI	-	3.8	-	ZR21

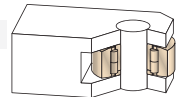

Cylindrical roller bearings for work roll thrust

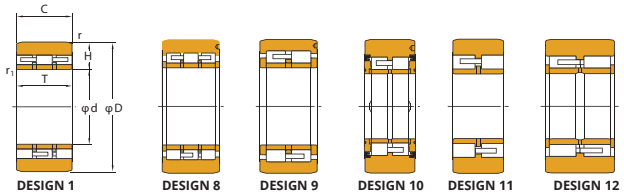

d(Fw)	D	T	C	Bearing No.	BMI Bearing No.	Bearing section height when manufactured (mm) H	Mass (kg)	Amount of bearings required per mill	Applicable multiroll mill type
50	120	80	80	10DC1280DS	10DC1280DSBBI	34.976	5.15	32	
50	120	85	85	10DC1285DS	10DC1285DSBBI	34.984	5.4	32	
60	160	95	95	12DC1695DS	12DC1695DSBBI	46.484	11.5	20 (32)	
65	170	100	100	13DC17100DS	13DC17100DSBBI	52.48	13.5	10 (34)	
90	230	100	100	18DC23100DS	18DC23100DSBBI	69.98	24.2	24 (34)	
100	260	95	95	20DC2695DS	20DC2695DSBBI	79.97	30.2	32	12HI
100	260	105	105	20DC26105DS	20DC26105DSBBI	79.97	33.5	32	
90	260	125	125	18DC26125DS	18DC26125DSBBI	84.97	41.3	34	
100	260	130	130	20DC26130DS	20DC26130DSBBI	79.97	41.5	32	
110	280	165	165	22DC28165DS	22DC28165DSBBI	84.965	60.2	10 (34)	
120	280	165	165	24DC28165DS	24DC28165DSBBI	79.965	57.7	14 (38)	
120	350	165	165	24DC35165ADS	24DC35165ADSBI	114.965	98.3	24 (34)	
130	350	175	175	26DC35175DS	26DC35175DS BBI	109.965	101	24 (38)	

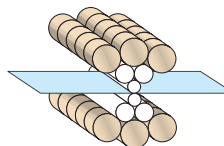

62	155	90	90	12DC1690DS	12DC1690DSBBI	46.484	9.97	8 (44)	
62	155	110	110	12DC16110DS	12DC16110DSBBI	46.484	12.2	36 (44)	
90	220	95	95	18DC2295DS	18DC2295DSBBI	64.982	20.9	40	
90	220	130	130	18DC22130ADS	18DC22130ADSBI	64.982	28.7	32,40	
115	260	140	140	23DC26140DS	23DC26140DS BBI	72.47	41.9	40	
65	165	70	70	13DC1770DS	13DC1770DSBBI	49.982	8.83	40	20HI
90	220	94	94	18DC2294DS	18DC2294DSBBI	64.976	21.2	40	
90	220	96	94	18DC2294/96DS	18DC2294/96DSBBI	65	21	64	
130	300.02	130	129	26DC30130DS	26DC30130DSBBI	85.01	52.2	56	
130	300.02	130	129	26DC30130BDS	26DC30130BDSBBI	85.01	51.8	-	
130	300.02	132	129	26DC30132ADS	26DC30132ADSBI	85.01	53.8	72	

